

# Fitseal™ Particulate Respirators Model #'s FS-400

**Fitseal**™  
RESPIRATOR

## USER INSTRUCTIONS: (Must be followed each time the FitSeal™ Respirator is worn.)

Apply over CLEAN and DRY skin. **CAUTION:** Do not place adhesive over any form of visible dermatitis, scabs, acne or other facial skin infections, open wounds or sensitive skin.



Do not apply over facial hair or stubble



Do not apply over cosmetics, moisturizers, creams, perfumes or other skin treatments



Do not touch adhesive with fingers



Do not remove both tabs before donning



Do not leave gaps at bridge of nose, cheek area and under chin



Do not re-use

## APPLYING THE Fitseal™ RESPIRATOR

Open wrapper at time of use. Ensure that exposed adhesive surfaces do not touch one another or other parts of the respirator. If the exposed adhesive comes in contact with another part of the respirator, discard respirator and begin with a new one.

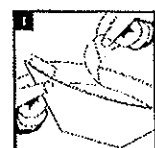

1. Remove the top release liner by pulling at the tab so that the adhesive is exposed.



2. Using the top centre alignment fold as a guide, place the respirator over the bridge of the nose just below the eye sockets.  
Press down firmly over both sides of the nose.



3. Remove the bottom release liner by pulling at the tab.



4. With the mouth closed, center the bottom of the respirator under the chin as close to the neck as possible. Press down firmly.

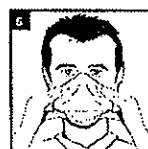

5. Using fingertips on both hands, pinch the top & bottom layers together, then press firmly against the cheeks.



6. Open mouth wide to stretch the material into position.

7. Press firmly around the adhesion portion of the respirator to ensure that there are no gaps or wrinkles in the material.

**Buddy/Visual Check:** When possible, ask a co-worker to inspect the face-to-respirator seal; alternatively, check the face-to-respirator seal in a mirror. Check visually to ensure that the adhesive is making complete contact with the skin. Any wrinkles should be pinched tightly so that the opposing edges stick together. There should be no gaps between the respirator and the skin.

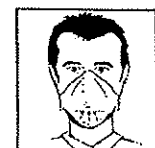

**User Seal Check:** To ensure a secure face-to-respirator seal, breathe in forcefully — the top layer of the respirator should collapse inwards on inhalation indicating that the respirator has a protective seal. Leaks may be detected on breathing in by a slight coolness on the skin at the respirator/skin interface. If leaks are detected, apply more pressure to the area to seal the leak. If you cannot achieve a proper fit, do not enter the contaminated area. See your supervisor.

## REMOVING THE Fitseal™ RESPIRATOR

**CAUTION:** Do not pull the respirator off the face without supporting the skin. There may be a slight pulling sensation where the adhesive comes in contact with the skin.



1. Starting at the point of the respirator closest to the ear, loosen the adhesive and peel the top of the respirator away from the skin across the bridge of the nose, while supporting the skin with the opposite hand, until the top of the respirator is detached from the skin.

2. Continue to pull the respirator down toward the chin keeping it close to the skin surface until it is fully removed.

To further loosen the adhesive, mouth the vowels "A" and "E" while opening and closing the jaws to their maximum.

**Note:** The outer surface of the respirator might contain harmful particles. Avoid touching the exterior surface when removing the respirator. Wash hands thoroughly after discarding.

**Disclaimer:** Fitseal™ respirator is not a medical product. It will not treat, cure, prevent or mitigate any human disease once infection occurs by inhaling airborne particles. If worn correctly according to user instructions, the Fitseal™ respirator can reduce or eliminate Total Inward Leakage and the penetration of airborne viral and bacterial sized particles from entering your lungs. Use once, 8 hours maximum and exercise care in its removal. Do not reuse. Check with your doctor if you are elderly, infirm or have any respiratory condition. Wein Products Inc., or any distributor that carries the said product makes no warranties or representations, either expressed or implied, that these products will fully shield the user from exposure to blood or body fluids or contracting infectious diseases.

**CWR, Environmental Products**

5155 Corporate Way, Ste G

Jupiter, FL 33458

1-800-444-3563

Website: [www.cwrenviro.com](http://www.cwrenviro.com)

**Fitseal™ Particulate Respirator  
Model #'s FS-400**

**Fitseal**  
RESPIRATOR

**WARNING:**

This respirator helps protect against certain airborne particles; it reduces, but does not eliminate the risks of inhaling pathogens. Failure to follow all instructions and warnings on the proper use of this respirator might reduce its effectiveness. Misuse may result in sickness or death.

**IMPORTANT:**

This innovative respirator design eliminates the need for straps and utilizes a medical-grade, hypoallergenic, latex-free adhesive that is widely used in many medical applications. Before use, the wearer **MUST** read and understand these instructions. Keep these instructions for reference. For additional information on proper use of this respirator, call:

- Wein Products Inc., in the U.S.A., at 1-213-749-6049 or
- FaceSeal Technologies Inc. in Canada, at 416-787-3247

**Use For:**

- Solids such as those from processing minerals, coal, iron ore, flour and certain other substances.
- Liquid or non-oil based particles from sprays that do not also emit oil aerosols, vapors or noxious gases.
- Biological particles. This respirator can help reduce inhalation exposures to certain airborne biological particles such as mold spores, *Bacillus anthracis* and *Mycobacterium tuberculosis*, but cannot eliminate the risk of contracting infection, illness or disease. OSHA and other government agencies have not established safe exposure limits for these contaminants.

**Do Not Use For:**

- Gases and vapors, including those present in paint spraying operations.
- Oil aerosols, which can destroy the filter.
- Oxygen - poor environments, such as tanks, sewers and other confined spaces.

**Use Instructions:**

1. Failure to follow all instructions and to recognize the limitations on the use of this respirator can reduce its effectiveness and could result in sickness or death.
2. Failure to wear this respirator during all times of exposure could also result in sickness or death.
3. Before occupational use of this respirator, a written respiratory protection program must be implemented meeting all the requirements of OSHA 29 CFR 1910.134 such as training and fit testing and applicable OSHA substance specific standards. In Canada, CSA standard Z94.4 requirements must be met.
4. The particles that can be dangerous to your health include those so small that you cannot see them.
5. Leave the contaminated area immediately and contact supervisor if dizziness, irritation or other distress occurs.
6. Store unused respirators away from contaminated areas and use each respirator only once.
7. Dispose of used products in accordance with applicable regulations.

**Use Limitations:**

1. This respirator does not supply oxygen. Do not use in atmospheres containing less than 19.5% oxygen.
2. Do not use when concentrations of contaminants are immediately dangerous to life or health, (IDLH), are unknown or exceed 10 times any governmental exposure limit such as OSHA's Permissible Exposure Limits (PEL's).
3. Do not alter abuse or misuse the respirator.
4. Do not use with beards, other facial hair or other conditions that prevent a good seal between the face and the seal of the respirator.
5. Respirators may help protect your lungs against certain airborne contaminants; however, they will not prevent entry through other routes such as the skin, which would require additional personal protective equipment.
6. Individuals with a compromised respiratory system, such as asthma or emphysema, should consult a physician and complete a medical evaluation prior to use.

**Time Use Limitations:**

If the respirator mask becomes damaged, soiled or breathing becomes difficult, leave the contaminated area and dispose of the respirator.



**Wein Products Inc.**  
Los Angeles, California 90007 USA  
1-213-749-6049



**THIS RESPIRATOR IS APPROVED ONLY IN THE FOLLOWING CONFIGURATION:**

TC-	Protection <sup>1</sup>	Respirator	Cautions and Limitations <sup>2</sup>
84A - 4651	N99	FS-400	ABCDJMOP

**1. Protection**

N99 - Particulate Filter (99% filter efficiency level) effective against particulate aerosols free of oils; time use restrictions may apply.

**2. Cautions and Limitations**

- A - Not for use in atmospheres containing less than 19.5% oxygen.
- B - Not for use in atmospheres immediately dangerous to life or health.
- C - Do not exceed maximum use concentrations established by regulatory standards.
- J - Failure to properly use and maintain this product could result in injury or death.
- M - All approved respirators shall be selected, fitted, used and maintained in accordance with MSHA, OSHA and other applicable regulations.
- O - Refer to users instructions, and/or maintenance manuals for information on use and maintenance of these respirators.
- P - NIOSH does not evaluate respirators for use as surgical masks.